

PRELIMINARY ASSEMBLY

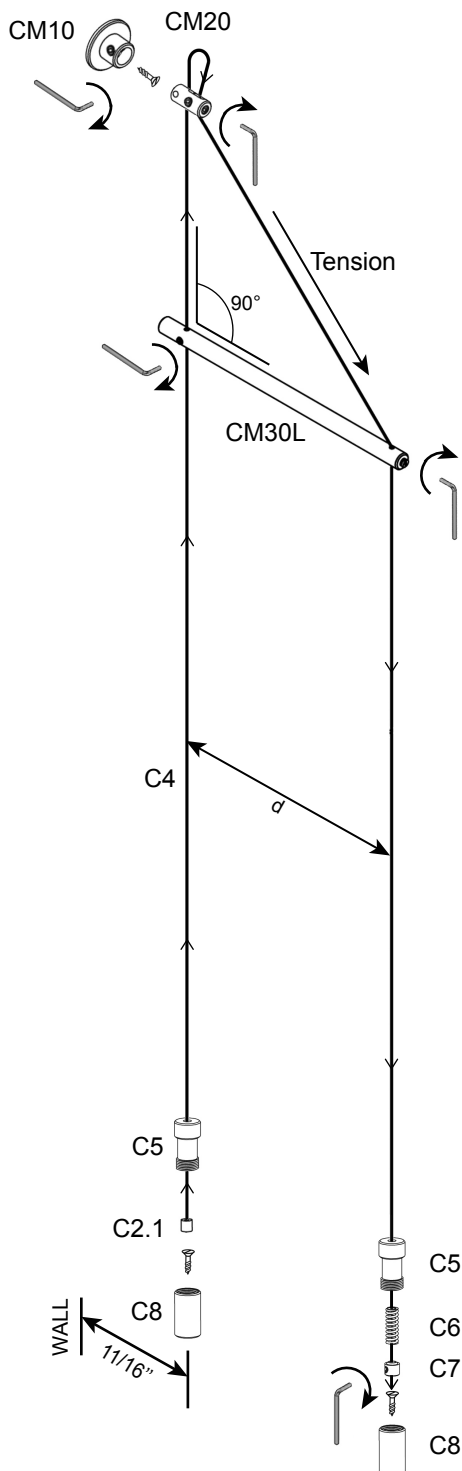
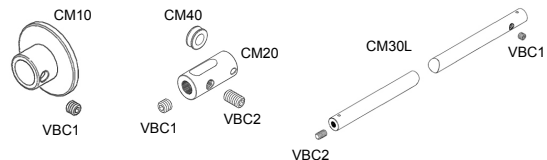

DISTANCE BETWEEN CABLES

CM30L1	d= 6-1/2" (16.6cm)
CM30L2	d= 9-1/4" (23.5cm)
CM30L4	d= 12" (30.5cm)

Installation instructions - System A

IMPORTANT

- It is the installer's duty to test the strength of wall, floor or ceiling and to decide on the most appropriate anchoring hardware.
- Anchoring hardware is not supplied by us.
- When cutting the cable use only a round cutter - never flat pliers or cutters as they will fray the ends of the cables.
- Do not use power tools to tighten cables systems or set screws.

INSTALLATION STEPS

1. Complete the preliminary assembly steps as shown.
2. Take accurate measurements of the shelves, rods or other displays to be suspended. Determine the top and bottom anchoring points.
3. Affix the CM10 to the wall at the height required and the two C8 to the floor. The C8 closest to the wall should be 11/16" from the wall. See below "d" for distance between the two C8.
4. Insert CM20 into CM10 and tighten in place.
5. Thread the cable, the end without the nipple through a C5 and screw the C5 into the C8 closest to the wall.
6. Thread the cable through the CM30L and the CM20 as shown in the diagram and tighten set screws. (Distance between the CM30L and the CM20 should correspond to the distance "d" of your CM30L).
7. Thread the cable through the other hole of the CM30L and tighten the VBC2 making sure that the CM30L is 90° to the cable.
8. Thread the C5, C6 and C7 onto the cable and loosely secure the C7 onto the cable to keep in place.
9. Cut off the excess cable so that the end is 3/4" above the floor. Position C7 approximately 1/4" from the end of the cable and tighten.
10. Screw the C5 into the C8. This will compress the spring and assure proper cable tension. If the cable is not taut enough raise the C7 slightly and repeat.
11. Once proper cable tension has been achieved, securely tighten all parts but do not screw the C5 completely into the C8. Leave about 1/4" unscrewed. The cable must be taut at this point. The 1/4" of play will allow you to further tighten the cable once it has stretched into place.

*These installation instructions are only to be used as **guidelines**. It is the installer's responsibility to ensure that anchoring hardware and materials used in any installation meet the demands of their intended purpose.*

