

IMPORTANT

- It is the installer's duty to test the strength of wall, floor or ceiling and to decide on the most appropriate anchoring hardware.
- Anchoring hardware is not supplied by us.
- When cutting the cable use only a round cutter - never flat pliers or cutters as they will fray the ends of the cables.
- Do not use power tools to tighten cables systems or set screws.

INSTALLATION STEPS

1. Take accurate measurements of the shelves, rods or other displays to be suspended. Define the top and bottom anchoring points by using a plumb line. (The distance between the cables should be equal to the width of the panel plus $\frac{3}{4}$ ".)

Affix the C1 to the ceiling. (top anchoring point)

2. Screw the C3 onto C1.

3. Affix the C8 to the floor. (bottom anchoring point)

4. Using the Allen key provided, unscrew and raise part C7 on the cable. Cut off the excess cable so that it is $\frac{3}{4}$ " above the floor.
5. *Do not detach the C7 from the cable, move it up before cutting it to the length you need.

Part C7 should be approximately $\frac{1}{4}$ " up from the bottom end of the cable.

6. Screw C5 into C8, this will compress the spring and assure proper tension on the cable.
7. If the cable is not tight enough, slightly raise part C7 on the cable and repeat. Should a larger adjustment need to be made, the excess cable should be trimmed off as instructed in Step # 5.

- Once proper tension has been achieved, securely tighten all parts but do not completely screw C5 into C8 leaving about $\frac{1}{4}$ " unscrewed. However the cable must be taut at this point. This will give room for the cable to be tightened once cable has stretched into place.

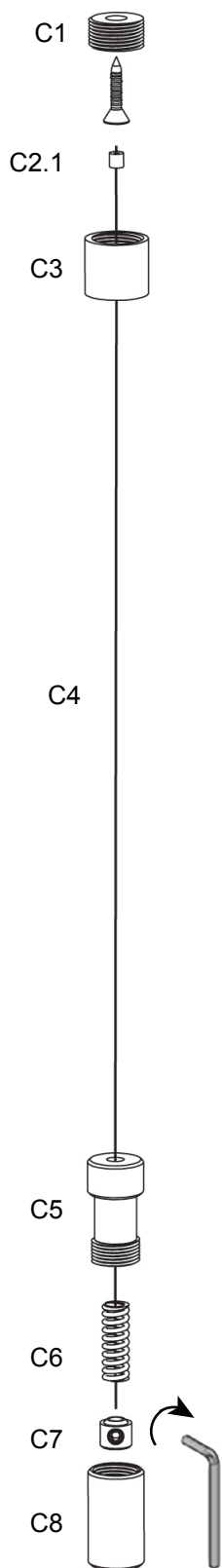

*These installation instructions are only to be used as **guidelines**. It is the installer's responsibility to ensure that anchoring hardware and materials used in any installation meet the demands of their intended purpose.*

